

*Name: æY/ 'k 'lY'Ga lH

*Service Address: %&' ('DjbY'FX

5brk \YfYZ'A =(- \$\$\$

*Nearest Cross Streets: A Ud'Y'FX/ 'CU 'FX

Fiber Service Site Plan

In the box below, draw your property and mark the approximate location for any underground facilities.

Items to mark may include:

- | | | | |
|---|--|------------------------------------|---|
| <input type="checkbox"/> Septic and drain field | <input type="checkbox"/> Pet fences | <input type="checkbox"/> Roadways | <input type="checkbox"/> Private electric lines |
| <input type="checkbox"/> Propane | <input type="checkbox"/> Sprinkler systems | <input type="checkbox"/> Buildings | <input type="checkbox"/> Landscaping lighting |
| <input type="checkbox"/> Satellite services | <input type="checkbox"/> Property lines | <input type="checkbox"/> Driveway | <input type="checkbox"/> Other private lines |

Please be sure to mark your preferred fiber route on the drawing using a dashed line (- - -).

***NOTE: The site plan below, and all fields marked with an asterisk (*), must be filled out and returned before Trustream/Great Lakes Energy can proceed with installation. Failure to do so will result in a delay of service.**

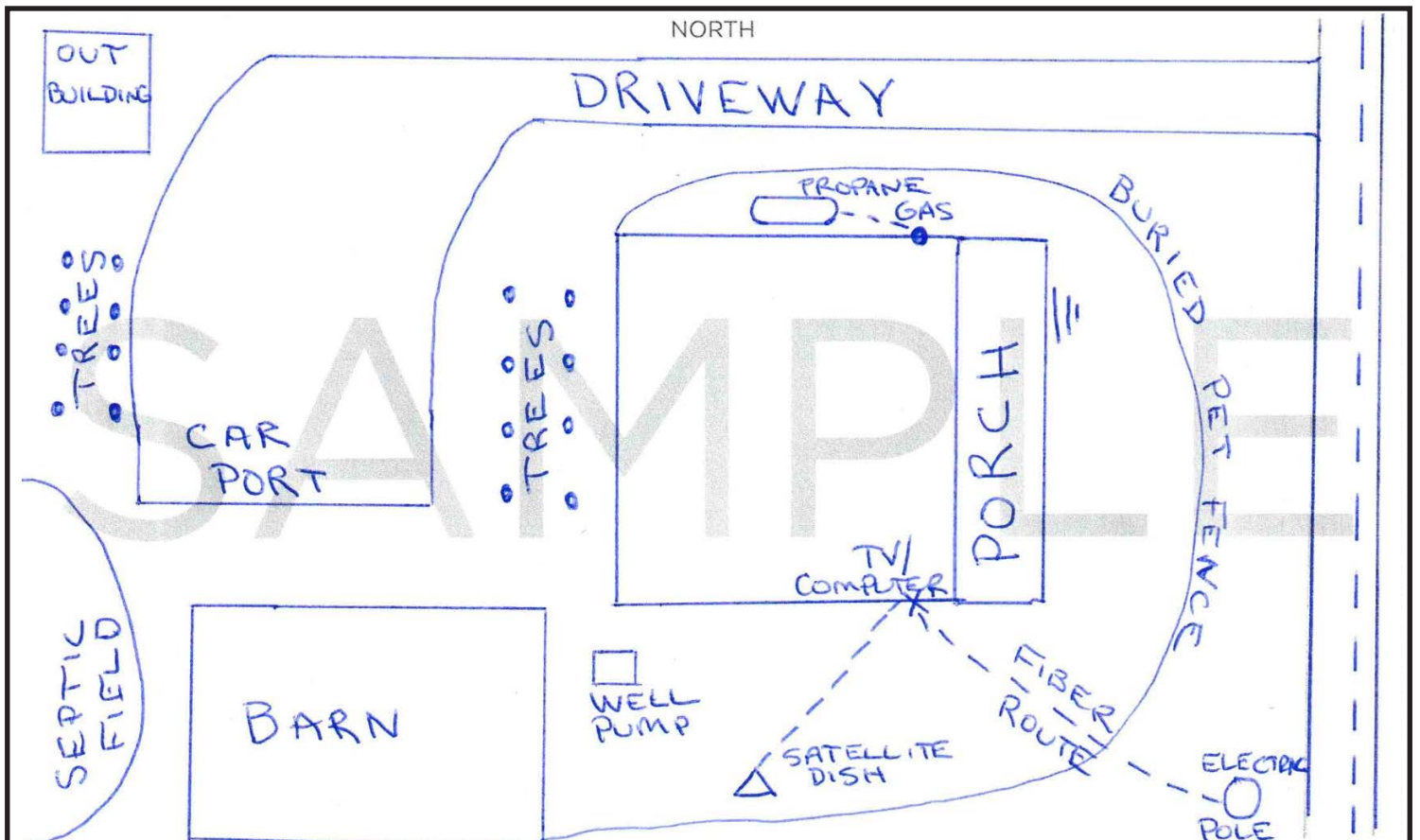

Trustream/Great Lakes Energy will contact MISS DIG to have all public utilities such as electric, natural gas, phone, and cable marked for you. **Once MISS DIG marks your property, please clearly mark your private underground facilities with the flags that will be provided by a GLE site planner.** A planner will visit your site to determine the best route of your fiber line and determine if additional permits or easements are needed/required. If you have questions, please call 1-888-485-2537.

***Please complete and return via:**

EMAIL: service@truestreamfiber.com

IN PERSON OR MAIL: Great Lakes Energy, 1323 Boyne Ave., Boyne City, MI 49712