

\*Name: Joe & Julie Smith

\*Service Address: 1234 Pine Rd  
Anywhere, MI 49000

\*Nearest Cross Streets: Maple Rd & Oak Rd

\*Phone Number: 555-555-5555 Date: 1/1/2022

## Fiber Service Site Plan

In the box below, draw your property and mark the approximate location for any underground facilities.

Items to mark may include:

- |   |  |                                    |   |
|---|--|------------------------------------|---|
| <input type="checkbox"/> Septic and drain field | <input type="checkbox"/> Pet fences        | <input type="checkbox"/> Roadways  | <input type="checkbox"/> Private electric lines |
| <input type="checkbox"/> Propane                | <input type="checkbox"/> Sprinkler systems | <input type="checkbox"/> Buildings | <input type="checkbox"/> Landscaping lighting   |
| <input type="checkbox"/> Satellite services     | <input type="checkbox"/> Property lines    | <input type="checkbox"/> Driveway  | <input type="checkbox"/> Other private lines    |
| <input type="checkbox"/> Electric meter         |  |                                    |   |

Please be sure to mark your preferred fiber route on the drawing using a dashed line (- - -).

**\*NOTE: The site plan below, and all fields marked with an asterisk (\*), must be filled out and returned before Truestream/Great Lakes Energy can proceed with installation. Failure to do so will result in a delay of service.**

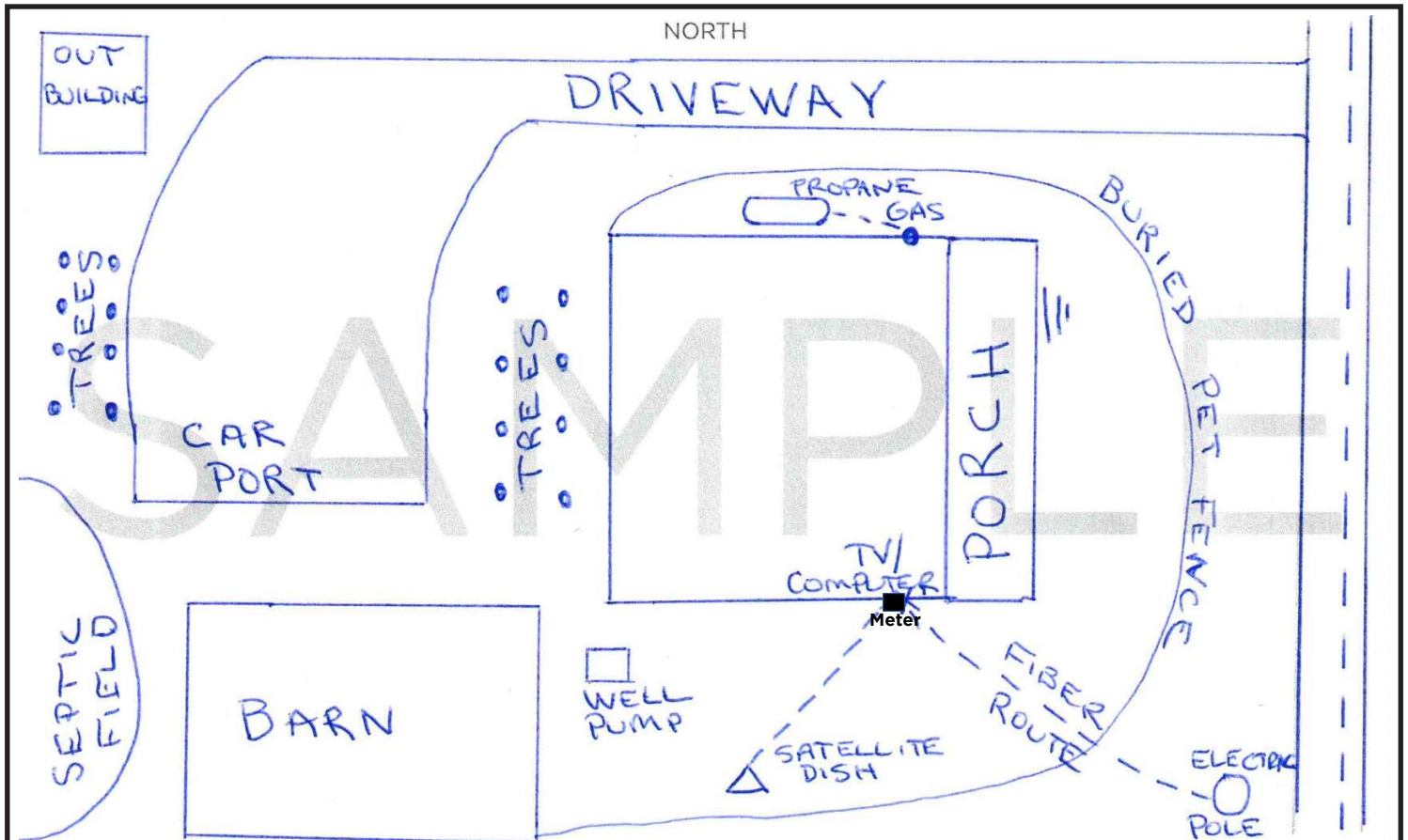

Truestream/Great Lakes Energy will contact MISS DIG to have all public utilities such as electric, natural gas, phone, and cable marked for you. **Once MISS DIG marks your property, please clearly mark your private underground facilities with the flags that will be provided by a GLE site planner.** A planner will visit your site to determine the best route of your fiber line and determine if additional permits or easements are needed/required. If you have questions, please call 1-888-485-2537.

**\*Please complete and return via:**

**EMAIL: [service@truestreamfiber.com](mailto:service@truestreamfiber.com)**

**IN PERSON OR MAIL: Great Lakes Energy, 1323 Boyne Ave., Boyne City, MI 49712**